

27 522 424 Product version from 1/1/2026



- spout: circular, air-enriched flow
- max. flow 20.4 l/min at 3 bar flow pressure
- Hand shower: COMPACT RAIN, max. flow rate 6.8 l/min (at 3 bar)
- complete hand shower set with anti-scale system
- 220mm projection
- automatic bath/shower diverter
- height of mixer 312 mm
- height up to aerator 215 mm
- hole diameter valve 32 mm
- hole diameter spout 32 mm
- hole diameter for complete hand shower set 32 mm
- rosette for complete hand shower set Ø 60mm
- rosette for spout Ø 60mm
- rosette for deck valve Ø 60mm
- metal shower hose 1750mm with integrated anti-twist protection

Intrinsic protection against back flow.

	Brushed Platinum	27 522 424-06
	Chrome	27 522 424-00
	Dark Chrome	27 522 424-19
	Brushed Durabronze (23kt Gold)	27 522 424-28
	Brushed Dark Brass (PVD)	27 522 424-39
	Brushed Bronze (PVD)	27 522 424-42
	Brushed Dark Bronze (PVD)	27 522 424-43
	Brushed Champagne (22kt Gold)	27 522 424-46
	Champagne (22kt Gold)	27 522 424-47
	Brushed Dark Platinum	27 522 424-99

27 522 424 Product version from 1/1/2026

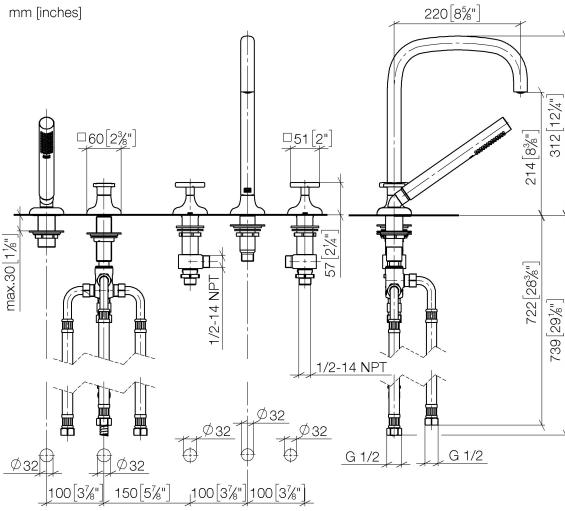

**Codes & Standards**

ASME A112.18.1      cUPC      DIN 4109      EN 1717

ISO 3822      Ü-Zeichen

**Certificates and sustainability**

LGA\_29      Belgaqua\_25-341-2 IAPMO\_4976 (

27 522 424 Product version from 1/1/2026

Parts for other finishes can be found here: [Chrome](#)

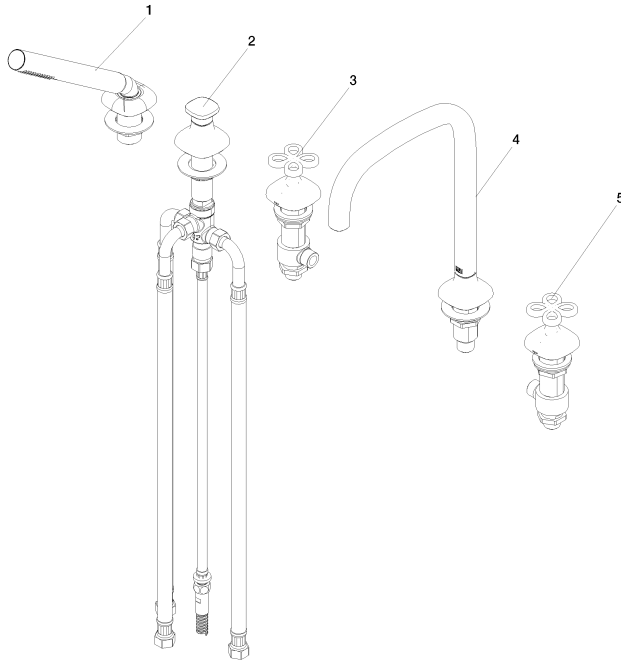

Spare parts list

No.	Item Number	Name	Quantity used	Delivery time
1	90 12 11 140 42-06	shower set	1.00	-
Spare part can no longer be ordered, please order the replacement item				
3	90 20 40 010 01-06	handle	1.00	26
2	90 20 40 006 00-06	diverter	1.00	26
5	90 20 40 010 02-06	handle	1.00	26
4	90 28 22 139 00-06	spout	1.00	-
Spare part can no longer be ordered, please order the replacement item				