

# MR02

## TOILET ROLL HOLDER

meir®

MATTE BLACK  
MR02



### EXPLODED VIEW

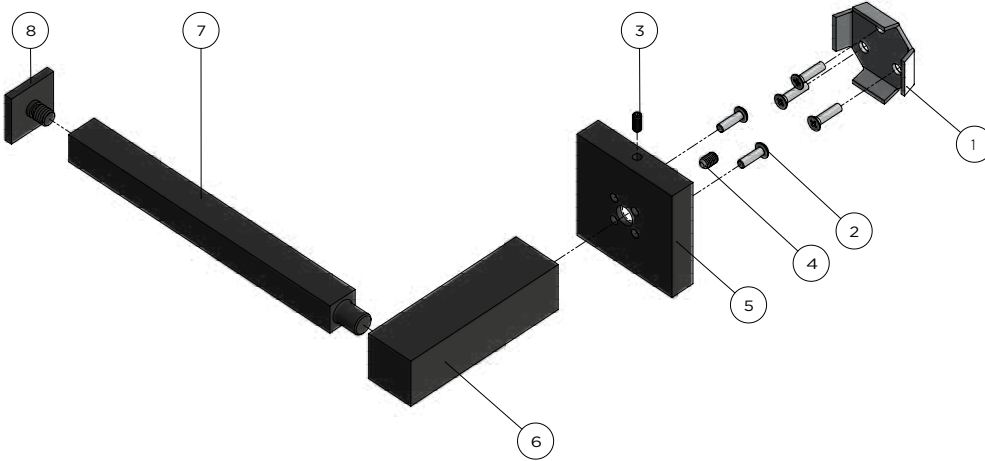

- |               |                    |
|---------------|--------------------|
| 1. Stator     | 5. Back plate      |
| 2. Screw      | 6. Fixed seat      |
| 3. Grub Screw | 7. Hook            |
| 4. Screw      | 8. Soldering Flake |

### CARE

- Do not install tapware using any form of acetone silicones.
- Do not apply physical items (such as tools) directly to product.
- Never use house-hold or commercial detergents, citrus based cleaners, or abrasive cleaners.
- Clean using a mild washing soap solution rinsed, and dry with a soft cloth.
- Check for any product defects before installation.
- Refer to the installation manual for correct installation.

### FEATURES

- 10 Year warranty
- Solid brass construction
- Box Weight 0.4

### SPECIFICATIONS

